

**EXHIBIT "A"**  
**EASEMENT ABANDONMENT**  
**ON**

LOT 1, BLOCK 1 OF TRACT 124, & LOT 1, BLOCK 4 OF TRACT 2129,  
LAKE HAVASU CITY, BEING A SUBDIVISION OF A PORTION OF SECTION 1, TOWNSHIP 13 NORTH,  
RANGE 20 WEST AND A PORTION OF SECTION 6, TOWNSHIP 13 NORTH, RANGE 19 WEST,  
GILA & SALT RIVER MERIDIAN, MOHAVE COUNTY, ARIZONA.

A PORTION OF LOT 1, BLOCK 1 OF TRACT 124, & LOT 1, BLOCK 4 OF TRACT 2129, LAKE HAVASU CITY, BEING A SUBDIVISION OF A PORTION OF SECTION 1, TOWNSHIP 13 NORTH, RANGE 20 WEST AND A PORTION OF SECTION 6, TOWNSHIP 13 NORTH, RANGE 19 WEST, GILA & SALT RIVER MERIDIAN, MOHAVE COUNTY, ARIZONA.  
BEING MORE PARTICULARLY DESCRIBED AS FOLLOWS:

SAID LOTS ARE MARRIED AS ONE LOT; THE 10.00 FOOT WIDE P.U.E. & D.E. BEING ABANDONED WAS ORIGINALLY ALONG THE WEST LINE OF SAID LOT 1, BLOCK 1 OF TRACT 124.

THE ABOVE DESCRIBED AREA CONTAINS APPROXIMATELY 1,400 S.F.

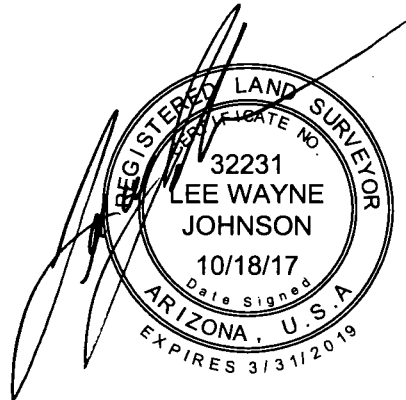

LOT 1, BLOCK 1 OF TRACT 124, & LOT 1, BLOCK 4 OF TRACT 2129,  
LAKE HAVASU CITY, BEING A SUBDIVISION OF A PORTION OF SECTION 1, TOWNSHIP 13 NORTH,  
RANGE 20 WEST AND A PORTION OF SECTION 6, TOWNSHIP 13 NORTH, RANGE 19 WEST,  
GILA & SALT RIVER MERIDIAN, MOHAVE COUNTY, ARIZONA.

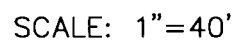
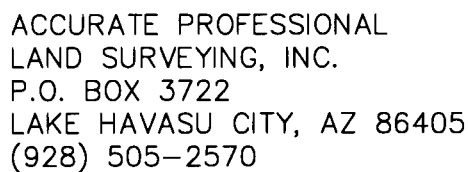

JOB No.  
2017-0928  
PAGE 2 OF 2