

EXHIBIT "A"
EASEMENT ABANDONMENT
ON

LOT 1, BLOCK 5 OF TRACT 2316, LAKE HAVASU CITY,
BEING A SUBDIVISION OF A PORTION OF SECTIONS 12 & 13, TOWNSHIP 13 NORTH,
RANGE 20 WEST, GILA & SALT RIVER MERIDIAN, MOHAVE COUNTY, ARIZONA.

A PORTION OF LOT 1, BLOCK 5 OF TRACT 2316, LAKE HAVASU CITY,
BEING A SUBDIVISION OF A PORTION OF SECTIONS 12 & 13, TOWNSHIP 13 NORTH,
RANGE 20 WEST, GILA & SALT RIVER MERIDIAN, MOHAVE COUNTY, ARIZONA.
BEING MORE PARTICULARLY DESCRIBED AS FOLLOWS:

COMMENCING AT THE COMMON REAR PROPERTY CORNER OF SAID LOT 1
AND LOTS 2, 3 & 4, BLOCK 5, TRACT 2316, LAKE HAVASU CITY;
SAID POINT BEING THE TRUE POINT OF BEGINNING;

THENCE, N. 58°44'00" E., ALONG THE COMMON REAR PROPERTY LINE OF
SAID LOTS 1 & 4, A DISTANCE OF 53.69 FEET;

THENCE, N. 31°16'00" W., LEAVING SAID PROPERTY LINE A DISTANCE OF
10.00 FEET;

THENCE, S. 58°44'00" W., ON A PARALLEL LINE TO THE COMMON REAR PROPERTY
LINE OF SAID LOTS 1 & 4, A DISTANCE OF 53.69 FEET TO A POINT ON THE
COMMON SIDE PROPERTY LINE OF SAID LOTS 1 & 2;

THENCE, S. 31°16'00" E., ALONG THE COMMON SIDE PROPERTY LINE OF SAID LOTS
1 & 2, A DISTANCE OF 10.00 FEET TO THE TRUE POINT OF BEGINNING.

THE ABOVE DESCRIBED AREA CONTAINS APPROXIMATELY 537 S.F.

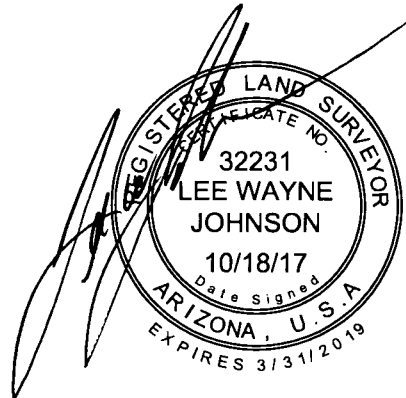

EXHIBIT "B" EASEMENT ABANDONMENT ON

LOT 1, BLOCK 5 OF TRACT 2316, LAKE HAVASU CITY,
BEING A SUBDIVISION OF A PORTION OF SECTIONS 12 & 13, TOWNSHIP 13 NORTH,
RANGE 20 WEST, GILA & SALT RIVER MERIDIAN, MOHAVE COUNTY, ARIZONA

