

COMMERCIAL
MOHAVE MENTAL HEALTH CLINIC INC.
APN: 107-30-001

COMMERCIAL
NAAR CAPITAL LLC.
APN: 107-30-002B

COMMERCIAL
MEH PROPERTIES LLC.
APN: 107-30-002A

LANDSCAPE ARCHITECT

KIMLEY-HORN AND ASSOCIATES, INC.
2046 WEST RIVERVIEW AUTO DRIVE, SUITE 400
MESA, ARIZONA 85201
TEL: (602) 371-4579
CONTACT: JACOB JURGENS
EMAIL: JACOB.JURGENS@KIMLEY-HORN.COM

OWNER REPRESENTATIVE

LAND DEVELOPMENT CONSULTANTS, LLC
11811 N. TATUM BLVD #4055
PHOENIX, ARIZONA 85028
PHONE: (602) 850-8101
EMAIL: MIKE@LDCAZ.COM
CONTACT: MIKE SCARBROUGH

CIVIL ENGINEER

KIMLEY-HORN AND ASSOCIATES, INC.
2046 WEST RIVERVIEW AUTO DRIVE, SUITE 400
MESA, ARIZONA 85201
TEL: (480) 748-7076
CONTACT: HEATHER ROBERTS
EMAIL: HEATHERD.ROBERTS@KIMLEY-HORN.COM

OWNER

CIRCLE K STORES INC
1120 WEST WARNER ROAD
TEMPE, ARIZONA 85284

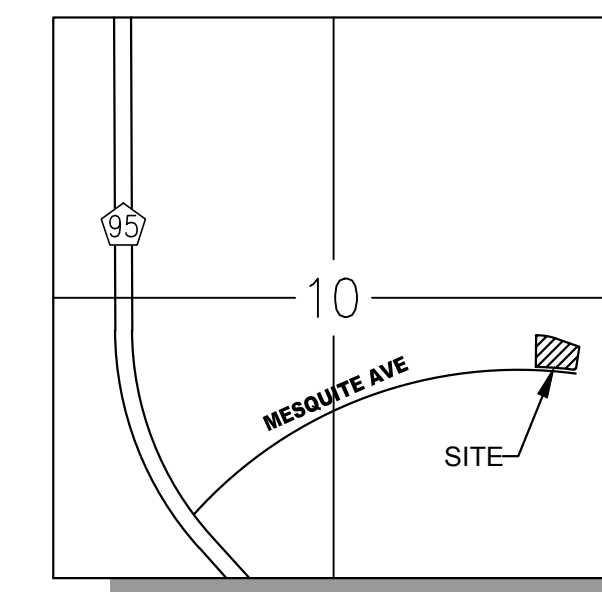

VICINITY MAP
MARICOPA COUNTY, ARIZONA
S10, T13N, R20W, G&SRB & M
N.T.S.

Kimley»Horn
© 2026 KIMLEY-HORN AND ASSOCIATES, INC.
2046 RIVERVIEW AUTO DR, SUITE 400
MESA, ARIZONA 85201 (480) 207-2666

COPYRIGHT NOTICE

THIS DRAWING IS THE PROPERTY OF THE ABOVE REFERENCED PROFESSIONAL AND IS NOT TO BE USED FOR ANY PURPOSE OTHER THAN THE SPECIFIC PROJECT AND SITE NAMED HEREIN AND CANNOT BE REPRODUCED IN ANY MANNER WITHOUT THE EXPRESS WRITTEN PERMISSION FROM THE PROFESSIONAL.

DATE: DESCRIPTION:

PROFESSIONAL SEAL:

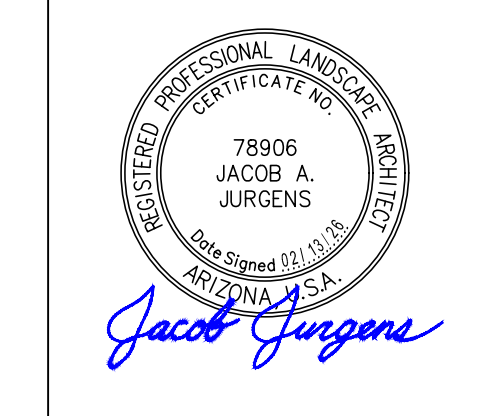

PROFESSIONAL IN CHARGE:

HDR
PROJECT MANAGER:
JAJ
QUALITY CONTROL:
JAJ
DRAWN BY:
JJO
DATE ISSUED:
02/04/2026

PROJECT NAME:

MESQUITE AVENUE &
RIVIERA DRIVE
LAKE HAVASU CITY,
AZ

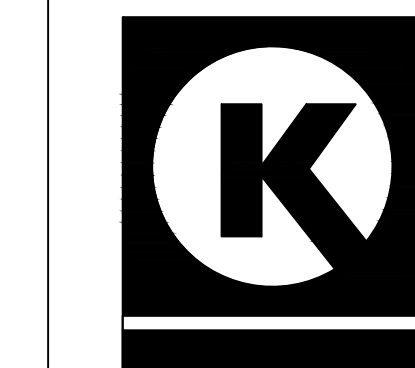

CIRCLE K STORES INC.

PROJECT NUMBER:

SHEET TITLE:

PRELIMINARY
LANDSCAPE PLAN

SHEET NUMBER:

01 OF 01

LAKE HAVASU CITY LANDSCAPE CODE

REQUIREMENT	REQUIRED	PROVIDED
GENERAL LANDSCAPE • 10% MIN. OF SITE TO BE LANDSCAPE (42,805 SF TOTAL) • 24 GAL. MIN. TREE SIZE • 5 GAL. MIN. SHRUB SIZE	4,281 SF PROVIDED PROVIDED	13,680 SF
STREETSCAPE MESQUITE AVENUE (105 LF) • 1 TREE PER 40 LF • 1 SHRUB PER 25 LF	3 TREES 5 SHRUBS	3 TREES 26 SHRUBS
STREET TREE SPECIES • 50% MAX. OF ONE SPECIES	PROVIDED	PROVIDED
PARKING LOT • 10% INTERIOR PARKING AREA TO BE LANDSCAPED (8,210 SF TOTAL) • 1 TREE PER 300 SF OF INTERNAL LANDSCAPE AREA (2,091 SF TOTAL)	821 SF 7 TREES	2,091 (25.5%) 7 TREES

PLANTING LEGEND

TREES

BOTANICAL NAME / COMMON NAME	SIZE	QTY
Acacia stenophylla Shoestring Acacia	24" Box, 1½" Cal. Min., 9' Ht. Min., 4' Sp. Min.	5
Parkinsonia 'Desert Museum' Desert Museum Palo Verde	24" Box, 1½" Cal. Min., 5' Ht. Min., 4' Sp. Min.	4
Prosopis x 'Leslie Roy' Thornless Mesquite	24" Box, 1½" Cal. Min., 6' Ht. Min., 6' Sp. Min.	7

SHRUBS & ACCENTS

BOTANICAL NAME / COMMON NAME	SIZE	QTY
Fouquieria splendens Ocotillo	5' Ht. Min., 6 Cane Min.	2
Hesperaloe parviflora Red Yucca	5 Gal.	52
Lantana camara 'New Gold' New Gold Lantana	5 Gal.	26
Leucophyllum langmaniae 'Rio Bravo' Rio Bravo Sage	5 Gal.	28
Mihlenbergia rigens Deer Grass	5 Gal.	10
Ruellia peninsularis Baja Ruellia	5 Gal.	22
Tecoma stans 'Gold Star' Yellow Bells	5 Gal.	24

MATERIALS

DESCRIPTION	QTY
Decomposed Granite 1" Screened, Madison Gold, 2" Depth Min.	13,520 SF

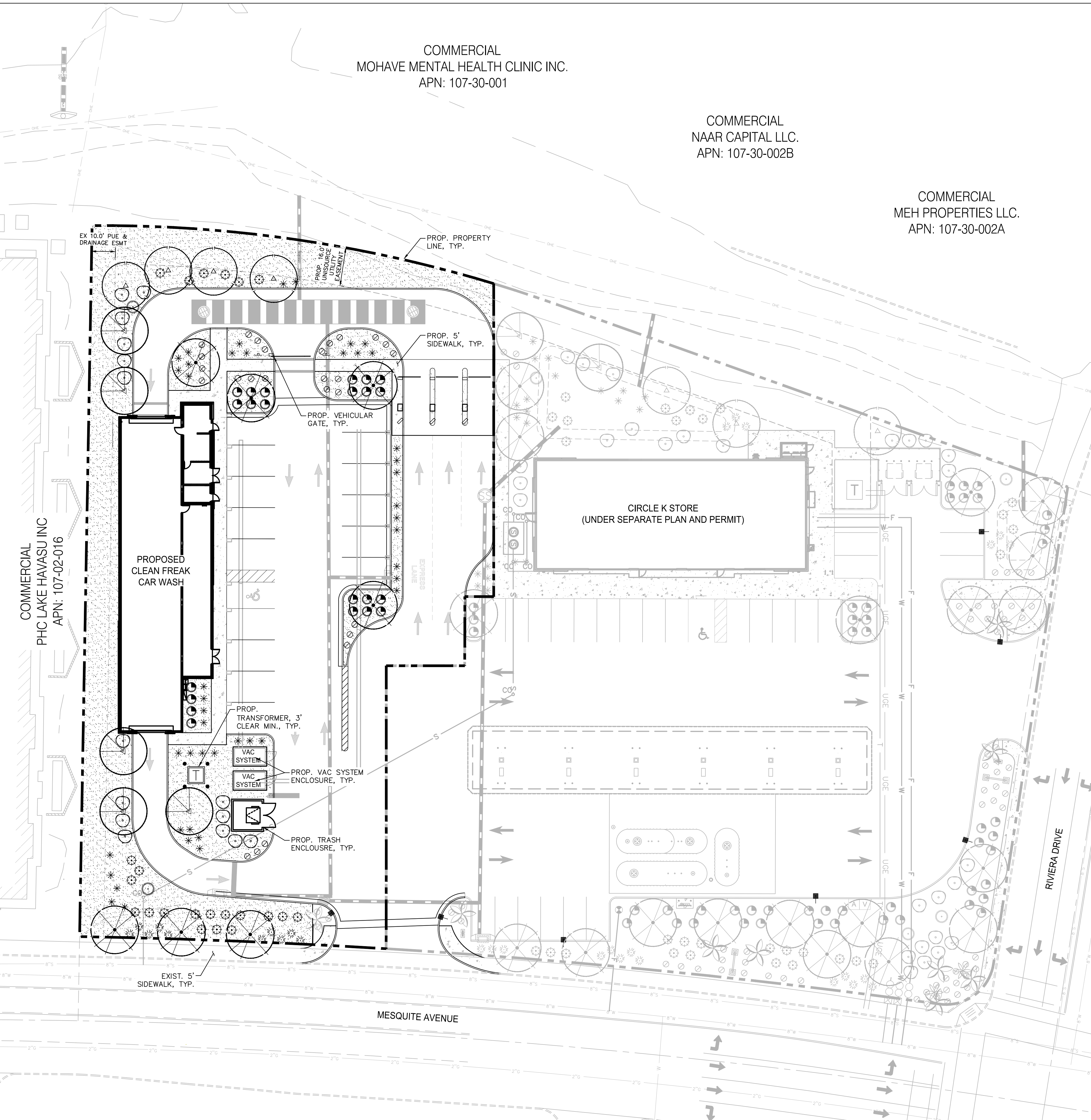
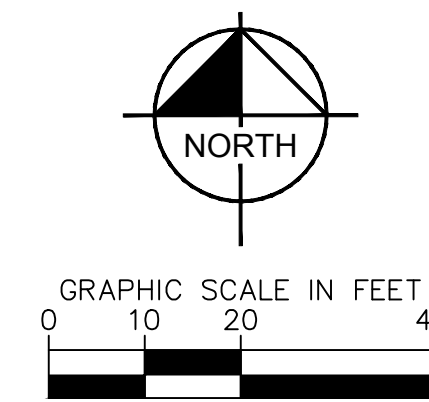

COMMERCIAL
PHC LAKE HAVASU INC
APN: 107-02-016

Drawing Name: K:\EAV_Civil\Circle K - Mesquite & Riviera\CD\DD\Plan\Car Wash\Carwash Prelim\Plan.dwg Last Modified: Feb 04, 2026, 5:08pm Plotted on: Feb 13, 2026, 9:14am by Jacob Jurgens